

# BALUSTRADE –GARDENS, TERRACES & BALCONIES

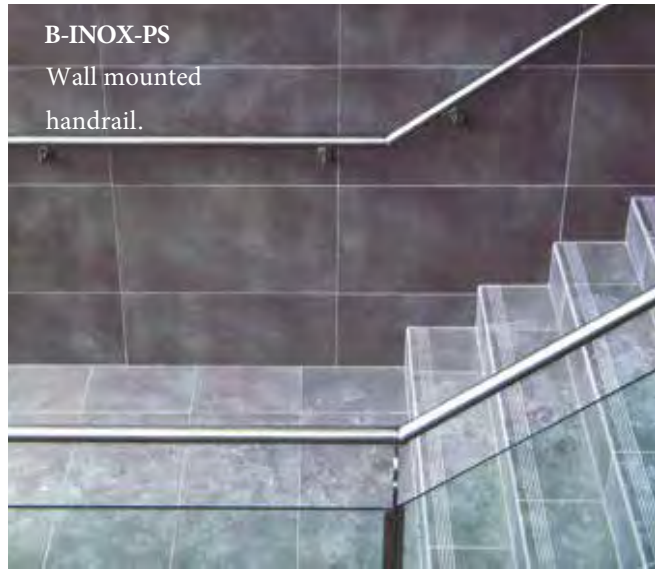

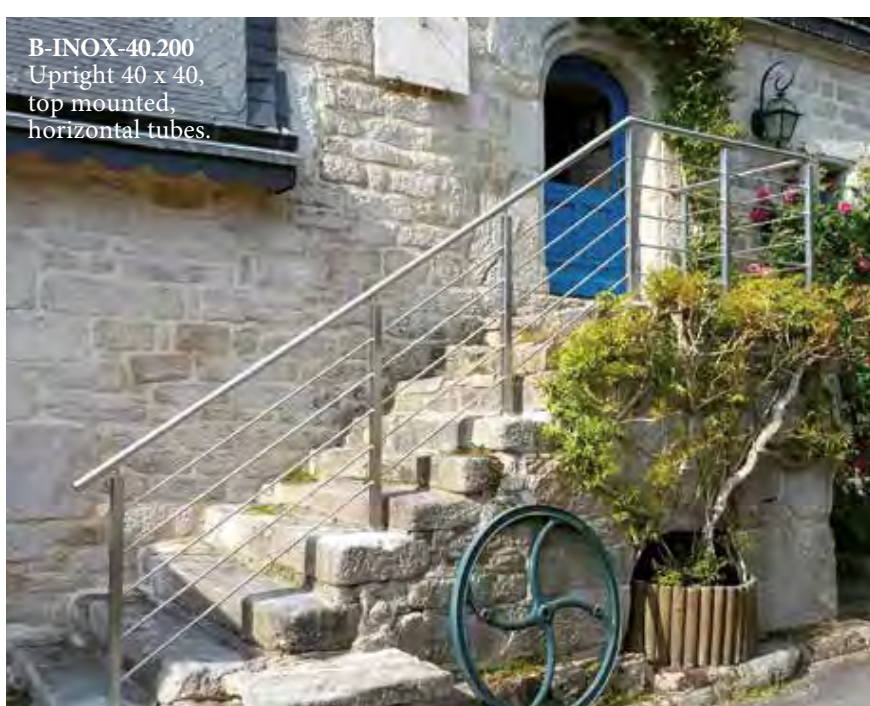

# BALUSTRADES – SWIMMING POOLS, WALLS, GATES

# AVANTAGES



**B-INOX-301**  
Upright 40 x 40,  
side mounted,  
clamps and glass.



**B-INOX-400**  
Solid upright 50x12mm,  
top mounted,  
front mounted clamps.



**B-INOX-410**  
Solid upright 50x12mm,  
side mounted,  
front mounted clamps.



**GATE OPTION**



**GATE OPTION**

**EASY TO MOUNT**  
We deliver each project ready to mount. It is not necessary to weld or cut on site in any moment.

- QUALITY**
- Marine quality 316L for out-door use, or in case of in-door use 304 is also available.
  - Solid upright 50 x 12 or tube upright 40 x 40.
  - Welding, cutting and mechanization are carried out in our installations, which assures a finish of a superior quality.
  - Available in brushed or polished finish.

**FLEXIBILITY**  
Send your drawings and description, and our technical department will make sure our balustrade fits your project. You will get a 3d drawing for approval.

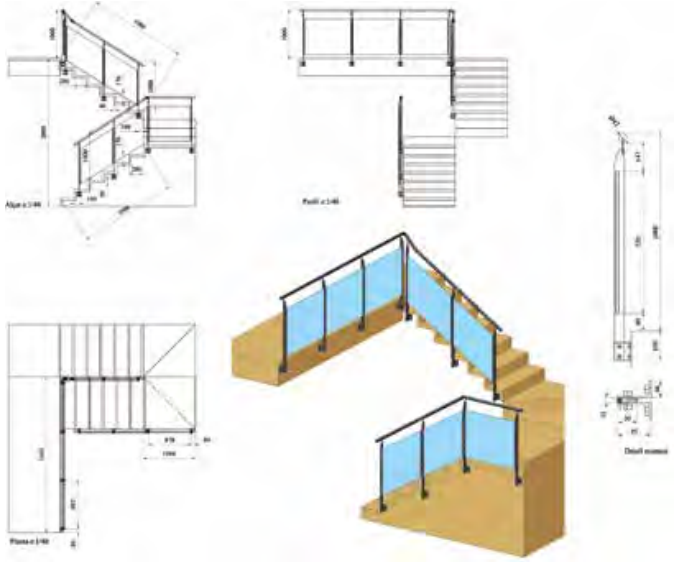

**B-INOX-40.200**  
Upright 40 x 40,  
side mounted,  
horizontal tubes.



**B-INOX-410**  
Solid upright 50x12mm,  
top mounted,  
front mounted clamps.

Become our distributor in your area. Please take contact for further information:

**CBM - Grup Blamar - Barcelona**  
[www.cbm.cat](http://www.cbm.cat) - Tel. +34 937951301-  
[beate@blamar.com](mailto:beate@blamar.com)

